

Instructions for use

Nemo

5100 5100

Shower-toilet chair



Important:

Read these instructions carefully before using the Nemo!

Date first used

User

Name

Address

Manufacturer

Lopital Nederland B.V.

Laarakkerweg 9

5061 JR Oisterwijk



The Netherlands

T +31 (0)13 5239300

F +31 (0)13 5239301

www.lopital.com

info@lopital.nl

Notes on symbols	
	Read the instructions for use before use.
	Note.

Contents

1.	Introduction	23
1.1.	Introduction	23
1.2.	Safety.....	23
1.3.	Warranty.....	25
2.	Use.....	25
2.1.	First use.....	25
2.2.	Working with the Nemo	25
3.	Operation	27
3.1.	Wheel blocking.....	27
3.2.	Footrest	28
3.3.	Armrest.....	29
3.4.	Head / neck support	30
3.5.	Tilting.....	31
3.6.	Toilet function.....	32
4.	Cleaning and maintenance	33
5.	Storage and transport.....	34
6.	Removal of parts.....	35
7.	Technical Specifications.....	35
7.1.	Structure.....	35
7.2.	Dimensions	36

1. Introduction

1.1. Introduction

The Nemo tilting shower and toilet chair is a medical device for caring for and washing clients in an ergonomically responsible manner. Comfort is the primary consideration for both the client and the carer.

The Nemo can also be used as a toilet chair, in combination with a bedpan / bucket. The Nemo comprises a base frame and chair component. The chair component provides the same comfort as a regular chair and offers the same degree of support. Compared to the undercarriage, the seat element can be tilted with support of a gas spring. The Nemo is thus a multifunctional device. The seat element of the Nemo can be tilted up to 30 degrees backwards. These functions are essential performances of the chair.

The average technical life of the Nemo is 10 years, assuming it is cleaned daily and regularly maintained according to the maintenance schedule supplied (*See Chapter 4 Cleaning and Maintenance*).

The Nemo is a class 1 product with CE-marking. This marking corresponds with directive 93/42/EC and the revised directive 2007/47/EC for medical devices of 21 March 2010.

1.2. Safety

A failure to comply with the following safety points and the further definitions in these instructions for use could lead to hazardous situations. Please read carefully before use.

Use

- Make sure that the Nemo brake is applied before transferring clients.
- Notify the client before moving the Nemo.
- Close the armrests with front closure before moving the Nemo upwards or tilting it.
- Make sure that the client always places his / her arms on the appropriate armrest in order to avoid anything becoming jammed.
- Keep the armrests or front closure down / closed when moving the Nemo.
- Be aware of obstacles when tilting.
- Only drive and manoeuvre the Nemo in a non-tilted position.
- When moving the Nemo, do not tilt.
- Always try to move backwards over obstacles (rather than forwards).
- It is not permitted to charge the Nemo with more than 150 kg / 330.7 lbs.
- The Nemo may not be used to transport loads other than people.



- Only use original parts, supplied by Lopital.
- The use of components (for instance the gas spring) that have not been supplied by Lopital may result in a dangerous situation.
- Use the Nemo in a clean and tidy working environment.
- Only verifiably authorised personnel is allowed to work with the Nemo.
- Swimming pool locations are not considered to be 'normal conditions' and will substantially shorten the lifespan of certain components.
- The Nemo cannot be used on a surface with a gradient over 5 degrees laterally.
- The Nemo cannot be used on a surface with a gradient of over 10 degrees forwards/backwards.
- During use of the Nemo, the water temperature may not exceed 43°C / 109.4°F.

Maintenance

- If the gas spring or the cable become damaged, they must be replaced.
- The Nemo must be inspected and serviced at least once a year.
- Servicing and maintenance of the Nemo may only be carried out by persons authorised by Lopital.
- Constructive components of the Nemo may only be replaced by suitably authorised Lopital personnel.
- If erroneous use, transport, an accident or improper maintenance leads to deformation of the Nemo, it may no longer be used and you must contact the supplier.

In the event of breakdowns, you must contact Lopital or your local supplier. E-mail: service@lopital.nl



The Nemo shower-toilet chair must only be operated by persons who have been sufficiently trained and expert personnel who have experience working with the target group.



The Nemo must be used in a clinical setting.



Making changes to the construction could affect the safety of the Nemo. This will also lead to Lopital's liability and warranty conditions being invalidated. As a result, the Nemo will no longer comply with the guidelines for medical devices.

1.3. Warranty

Lopital products are guaranteed for 2 years with respect to construction and / or material faults. In the event of varying warranty terms, the exact period will be indicated on your invoice; this also serves as the warranty itself.

Components that are subject to wear and tear will not fall under warranty unless there are clear construction and / or material faults.

2. Use

2.1. First use

Before you use the Nemo, you must check to ensure the components on page 26 are present. These components can be replaced by authorised individuals in the event of damage.

These components are the applied parts of the Nemo. These components may come into contact with the user(s) while the Nemo is in use.

2.2. Working with the Nemo

Step 1

Make sure that the Nemo is placed in the sitting position and fold the armrests upwards (See paragraph 3.3. *Armrest*).

Step 2

If necessary, fold the foot plates up or remove the footrests from the Nemo (See paragraph 3.2. *Footrest*).

Step 3

The Nemo must be put on the brakes before transferring persons (See paragraph 3.1. *Wheel blocking*).

Step 4

The client can take a seat in the chair. Support the client if necessary.

Step 5

Place both feet on the footrests and calves against the calf-supports. (See paragraph 3.2 *Footrest*).

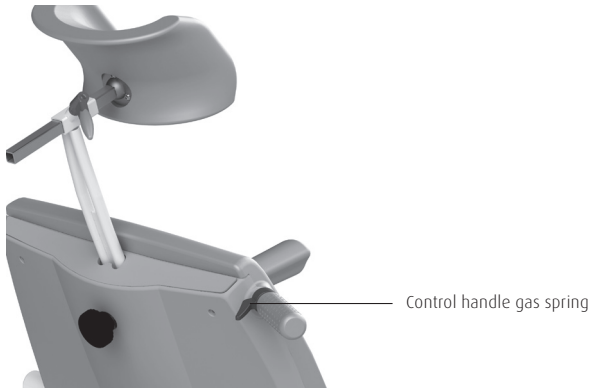

Step 6

Fold the arm supports downwards after the impaired person has sat down in the chair (See paragraph 3.3. *Armrest*).

Step 7

Notify the client about the processes you will be carrying out.

Step 8

Take the chair off the brake when you wish to move it (See paragraph 3.1. *Wheel blocking*).

Step 9

When you wish to tilt the chair, you must apply the brake (See paragraph 3.5. *Tilting*).

3. Operation

3.1. Wheel blocking

- The brake can be applied on the Nemo by pushing the blue lip (1) on the wheel downwards (See figure 1).
- In order to take the Nemo off the brake, the same lip on the wheel must be moved upwards by tapping the upper side of the lip (2) (See figure 1).

Option: Swivel wheel left front (Article number: 75560025).

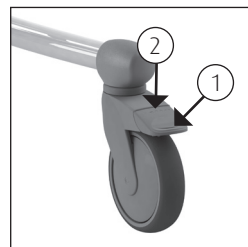

Figure 1 Swivel wheel.

3.2. Footrest

- Before the client takes a seat in the Nemo, the foot plates must be folded upwards. This will ensure there is sufficient space for the person to easily take a seat in the chair (See figure 2). If more room is required, the foot rests can be turned out (See figure 3). First, the foot rests must be slightly raised (1) and then they can be turned outwards (2).
- The carer or the client first raises one leg; the carer can then fold the foot plate down (See figure 4). The same procedure is then carried out with the other leg.

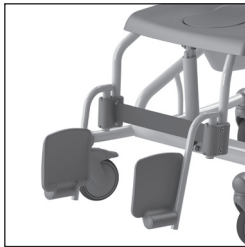

Figure 2 Folding up foot plates.

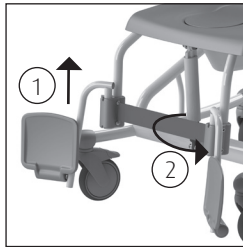

Figure 3 Turning out footrests.



Figure 4 Folding down foot plates.



Always replace this component on the chair when you have finished using it. This will avoid the component being lost.

Option: Comfort leg support (Article number 6960 8026)

The comfort leg support provides the legs with additional support. The comfort leg support can be adjusted in length as well as according to the sitting angle. The angle of the leg support can be adjusted to 4 positions, as shown in figures 5, 6, 7 and 8. To change the seating angle, you have to release the locking pin. When you have determined the correct position, lock the sitting angle of the comfort once again (See figure 9).

Make sure that the locking pin slips in well into one of the 4 holes.



To adjust the length of the leg support, you have to release the locking pin underneath by loosen it a bit (See figure 9). Choose the right length for the leg support and tighten the locking pin again.



Make sure that both the sitting angle and the length of the leg support are locked properly as soon as they have to support a load.



Always place these parts on the seat as soon as you finish using them. This prevents you from looking for the parts.

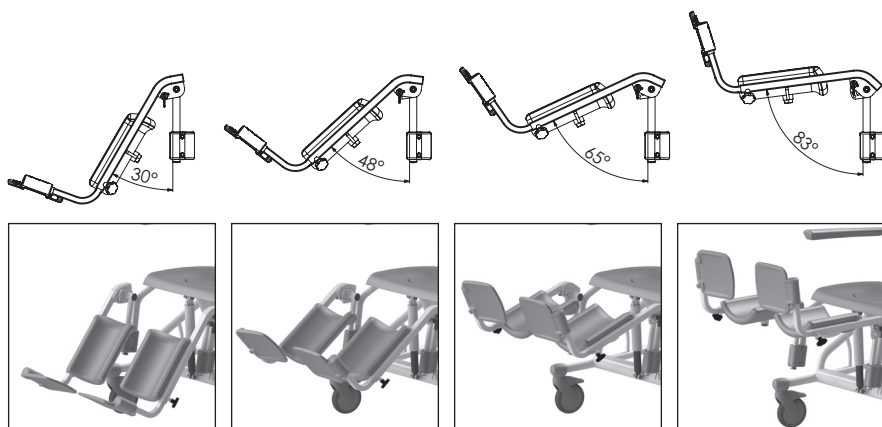

Figure 5 t/m 8 Adjustable seating angle.

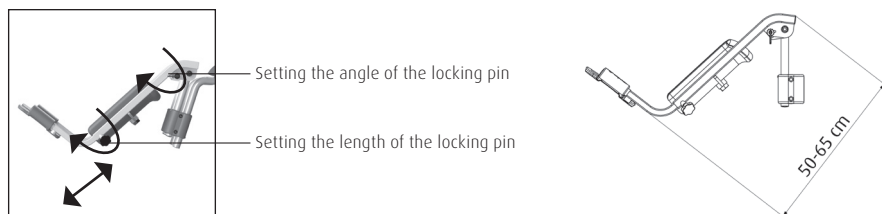

Figure 9 Locking pins.

3.3. Armrest

- The independent folding armrests are easy to fold up.
- Protect the user when moving the armrests upwards and downwards.
- In the folded up position, they should not fall back down by themselves; in other cases: consult your supplier.



Figure 10 Armrest Nemo.

Option: Armrest with front closure
(Article number: 6840 5660).

- When the client has taken a seat on the Nemo, the armrests with front closure can be folded down; these are then turned in front of the client.
- The armrests with front closure are secured in a horizontal position.
- The armrests can be unlocked by pressing the security catch at the hinging point on the frame (See figure 11). The armrest can then be turned up for the client and folded up.
- Always protect the client when folding the armrests up or down.
- The armrests can also be used as a support when taking a seat or standing up.
Be aware that the armrests are not locked in all positions.

Option: Dual locking (Article number: 6840 5661).

- The extra lock ensures that the front closure is also locked when turned away (See figure 13).



Figure 11 Armrest with front closure.

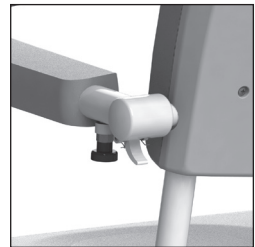

Figure 12 Armrest with dual locking.



Figure 13 Armrest turned out.



When folding the armrests away, avoid fingers or body parts becoming jammed between the armrest and the back support.



The armrest or front closure must not be used as a lever arm (e.g. when moving the chair over an obstacle) or as a push / pull bar. You must not sit on it either. This could damage the Nemo and / or present a hazard.

3.4. Head / neck support

- The Nemo has a head / neck support that can be adjusted in terms of both height and depth.
- In order to set its height, the rotating button (1) on the back of the chair must be undone. Once you have reached the required height, do the button up again (See figure 14).

- To set the depth of the head / neck support, the handle (2) is unlocked. Once you have reached the required height, do the handle up again. The depth setting has a range of 7 cm.
- The Nemo has a curved head / neck support, allowing the head of the client to be supported effectively.

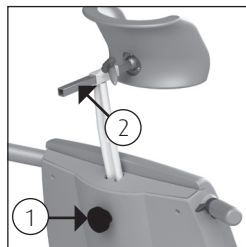

Figure 14 Head support.

Always replace this component on the chair when you have finished using it. This will avoid the component being lost.

3.5. Tilting

- In order to tilt the nemo in an ergonomic and responsible manner, the operator should be standing diagonally behind the Nemo. Grasp the hand grip using your right hand (1). Using the left hand, hold the frame of the head support firmly (2) (See figure 15). The chair frame can be tilted by squeezing the operating handle.
- The Nemo is equipped with a tilting function up to a maximum of 30° backwards. This function can be operated by pressing the control handle. The seat element will then tilt (See figure 16).
- To operate the tilt function you must put the Nemo on the brake.
- The caregiver can stop the tilting at any time by releasing the handle.
- To tilt the Nemo forwards the control handle can be used again (See figure 16).
- During the tilting the arm supports must be folded downwards and the arms of the client must rest on the arm supports.
- In addition, during the tilting the client must have placed his / her feet on the foot support.
- Maintain contact with the client during the tilting.

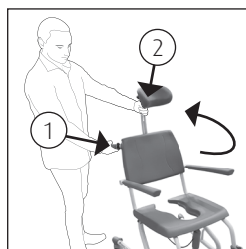

Figure 15 Tilting Frame.

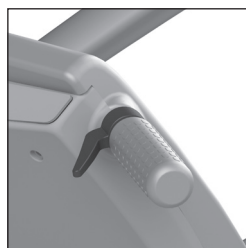

Figure 16 Control handle.

Before tilting the chair, check to ensure there are no persons or objects in the vicinity of the chair.

3.6. Toilet function

3.6.1. In combination with toilet

- The Nemo can also be moved over the toilet.
- Remove the lid on the seat before the person sits down in the chair.
- The Nemo can now be moved backwards over the toilet.



The Nemo does not fit over every toilet.

3.6.2. Use of a bedpan or bucket

- If the Nemo is being used as a toilet chair, the special guides under the seat can be used to accommodate a stainless steel / plastic bedpan or bucket.
- The bedpan or bucket is slid in from the back of the chair (See figure 17).
- If you are using the Lopital plastic bedpan, you must slide it as far forwards as possible (See figure 18).
- If you are using a stainless steel bedpan or bucket, the bedpan can be placed in 2 positions under the seat. At the front of the seat (See figure 19) or at the back of the seat (See figure 20).



In order to avoid injuries, we advise the carer to remove the lid from the seat and insert the bucket or bedpan before the client takes a seat on the chair.



The Lopital plastic bedpan, stainless steel bedpan and bucket must be cleaned and disinfected after use, for example in a bedpan washing unit.



If the Lopital plastic bedpan, stainless steel bedpan or bucket has been used, it must be removed from the chair before the chair is moved or adjusted in height.

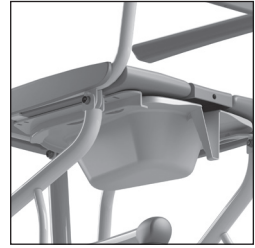

Figure 17 Bedpan.



Figure 18 Lopital plastic bedpan.



Figure 19 Stainless steel bedpan, front.



Figure 20 Stainless steel bedpan, back.

4. Cleaning and maintenance

The Nemo must be cleaned after every use, with water and regular household cleaning agents. Remove excess soap residues. PUR integrated foam components with IMC coating should be rubbed clean and disinfected. Do not use any abrasive or other aggressive cleaning products (e.g. chlorine bleach). Practical experience has shown that regular household cleaning agents with limited alcohol content (max. 5%) are most suitable for this purpose. The product Neoquat combi® is recommended for disinfection purposes (on the basis of long-term testing). If necessary, the PUR components can be cleaned with a solution of 70% ethanol or propanol.

You must ensure that both the disinfecting and cleaning processes involve the components being rubbed and not just submerged. The time the products must be left on the components has a significant impact upon the lifespan of the PUR components. As a result of the material properties of PUR, contact with sharp objects must be avoided. This could lead to damage or tears in the material. Finally, we would like to point out that non-critical parts of the PUR components must also be cleaned and decontaminated.

Check the wheels regularly for hairs, dust and soap residues and remove when necessary. Maintenance and repairs to the Nemo may only be carried out by authorised personnel.

Maintenance schedule	
After every use	<ul style="list-style-type: none"> • Clean chair with water and regular household cleaning products.
Daily	<ul style="list-style-type: none"> • PUR foam components must be cleaned and disinfected. • Check to ensure all parts of the Nemo are present, including the footrests, head support and filler piece for the seat.
Weekly	<ul style="list-style-type: none"> • Clean frame. • Check wheels for hairs, dust and soap residues and remove if necessary. • Check that the chair is still working correctly.
<p>Annually</p> 	<ul style="list-style-type: none"> • According to the guidelines for medical devices, a chair must be maintained in line with the manufacturer's instructions. This process will preferably be carried out by Lopital or another authorised body. Lopital offers the option of having the chair thoroughly inspected and serviced once a year via Periodic Preventative Maintenance. <p>For more information about the maintenance contract, please contact Lopital (service@lopital.nl) or speak to your supplier.</p>

5. Storage and transport

During transport and storage, the ambient conditions must remain moderate. In other words, the temperature should remain between -40 and +55 degrees Celsius (-40 to 130 degrees Fahrenheit) and humidity levels should be kept as low as possible. Vibration during transport must be kept to a minimum in order to avoid damaging the hinged mechanisms on the chair.

6. Removal of parts

All parts that are replaced or removed can be sent back to Lopital BV. You may also offer the parts to the engineer for destruction. We will ensure that all parts are processed in an environmentally-friendly manner.

7. Technical Specifications

The Nemo is splash-proof. This is indicated by the IPX4 mark.

7.1. Structure

Frame:	Stainless steel and steel tubes and plates that are equipped with a 2-layer powder coating
Hinge points:	stainless steel
Wheels:	plastic, Ø 12.5 cm / 4.9 inch, double blocking facility
Body support :	PUR (polyurethane).
Weight:	24.5 kg / 54 lbs
Maximum permitted load:	150 kg / 330.7 lbs
Weight comfort leg support:	3.6 kg / 7.9 lbs per unit

7.2. Dimensions

Surface area:

66 cm / 26 inch wide, 97 cm / 38.2 inch deep

Head support adjustment:

depth 7 cm / 2.8 inch & height 12 cm / 4.7 inch

Tilt adjustment:

30° backwards

